

Manometer $\varnothing 63^{3/8}$ "/4 bar

- Application in sanitary and heating systems
- Pressure gauge with connected connection adapter G $3/8$ "
- Diameter: 63 mm
- Pressure range: 0 - 4 bar
- Note: adapter thread need to be sealed



Code

MANOM63-3/8-4B

Shut-off valve for manometer $3/8$ "

- Adapter with shut-off valve for manometer $3/8$ "
- Manometer connection: internal thread G $3/8$ "
- External connection: external thread G $3/8$ "



REM 8-3/8

Manometer $\varnothing 63^{1/4}$ "/10 bar

- Application in sanitary and solar systems
- Diameter: 63 mm
- Pressure range: 0 - 10 bar
- Connection: external thread G $1/4$ "



MANOM63-1/4-10B

Shut-off valve for manometer $1/4$ "

- Adapter with shut-off valve for manometer $1/4$ "
- Manometer connection: internal thread G $1/4$ "
- External connection: external thread G $1/4$ "



REM 8-1/4

Automatic air vent valve Minivent MV10.R $3/8$ " 12 bar

- Automatic venting of closed heating systems
- Maximum temperature: 115 °C
- Maximum pressure: 12 bara
- Connection: external thread G $3/8$ "
- Equipped with adapter G $3/8$ " with automatic shut-off valve



MINIVENT MV10R

Quick-disconnect coupling SK $3/4$ "

- Quick-disconnect coupling for connecting the expansion tank
- Set:
 - External thread G $3/4$ " fitting with automatic shut-off valve
 - Union nut G 1"
 - Adapter with automatic shut-off valve:
 - Nut connection: external thread G 1"
 - Expansion tank connection: internal thread G $3/4$ "

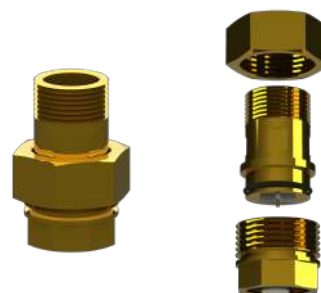

BRZA SPOJNICA SK3/4